



TRIPLEEase™

Twin CAM VME handles

Extruded all-aluminum ejector handles that meet VME and VXI standards and backed by a lifetime warranty against breaking

Triple E established a tradition of rugged, durable, extruded, all-aluminum Eurocage components when we introduced the patented twin CAM VME handles. Triple E is so confident of the strength and durability of our all metal handles, we warranty them for lifetime against breaking. Triple E supplies completely assembled front panels ready for PCB mounting. We will machine your individual hole configurations on our CNC equipment to meet your exact requirements



TripleEase™ low profile twin CAM VME handles are available in short (SM) and long (LM) versions to provide maximum leverage for easy and complete extraction.

TripleEase™ (VM) and (VX) Twin and Quad CAM handles have the traditional VME look and may be ordered to support panels up to 16HP (3.2") wide.



(Twin CAM handles pictured on left and Quad CAM handles pictured on right)

Feature

All metal extruded handle

Twin and Quad CAM design

Durable powder coat finish

Meets IEEE 1101.1 specifications for VME and VXI applications

Benefit

- ✓ Will not break, outgas, melt, burn or bend
- ✓ Solid surface for a Lexan or Mylar ID label to attach and stay
- ✓ One handle for single, double, triple and quad wide panels
- ✓ No sharp edges
- ✓ .200" eject travel vs. .150" typical with plastic
- ✓ Complete extraction of PCB from backplane
- ✓ Applies even ejection pressure across panel reducing stress on PCB even with stacked boards or wide panels
- ✓ Easier to assemble than plastic, saves time
- ✓ Chip, wear and scratch resistant
- ✓ Standard finish is aluminum fine texture or black medium texture
- ✓ Rugged, durable, industry standard components at competitive prices
- ✓ Traditional look will match plastic handles
- ✓ Low profile version provides maximum leverage for easy extraction

US Patent 5,428,507

Triple E Corporation, 60 Foot of Crosby Street, Lowell, MA USA 01852
Tel: (978) 453-0600, Fax: (978) 453-1196, email: info@TripleEase.com

www.TripleEase.com

Twin CAM VME handles

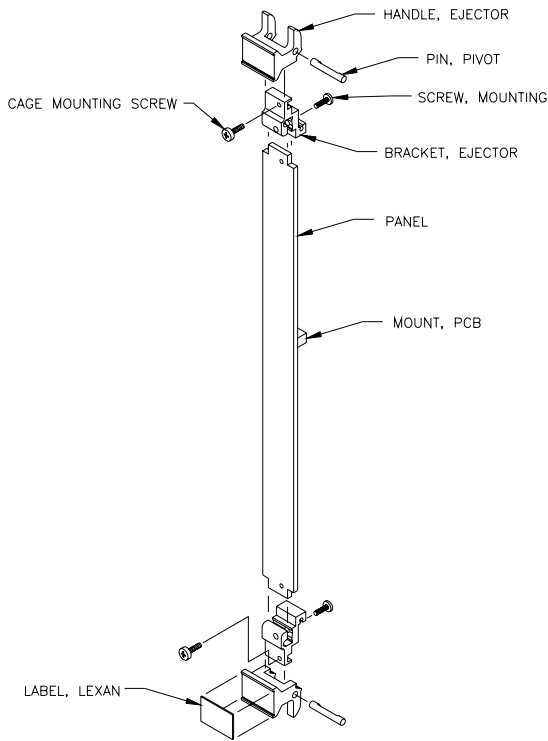

Triple E offers extruded fixed handles that are designed with a linear thread that accepts a standard 2,5mm screw. These are available in almost any length.

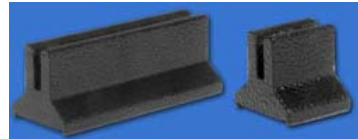

Continuing our tradition of extruded manufacturing, Triple E has added handle couplers to our list of unique product offerings. Designed to work on twin CAM handles and most plastic handles. This allows the user to join multiple front panels together allowing greater ease for removing or installing boards. Available in several standard widths from 8HP through 16HP. These couplers are held in place with the use of socket set screws.

Twin CAM handle coupler part numbers:

Width	Part Number
8HP	HCK-8-X
12HP	HCK-12-X
16HP	HCK-16-X

X = Powder coat finish. See below chart for finish

Order information:

